

Attachment A

Identification Plans

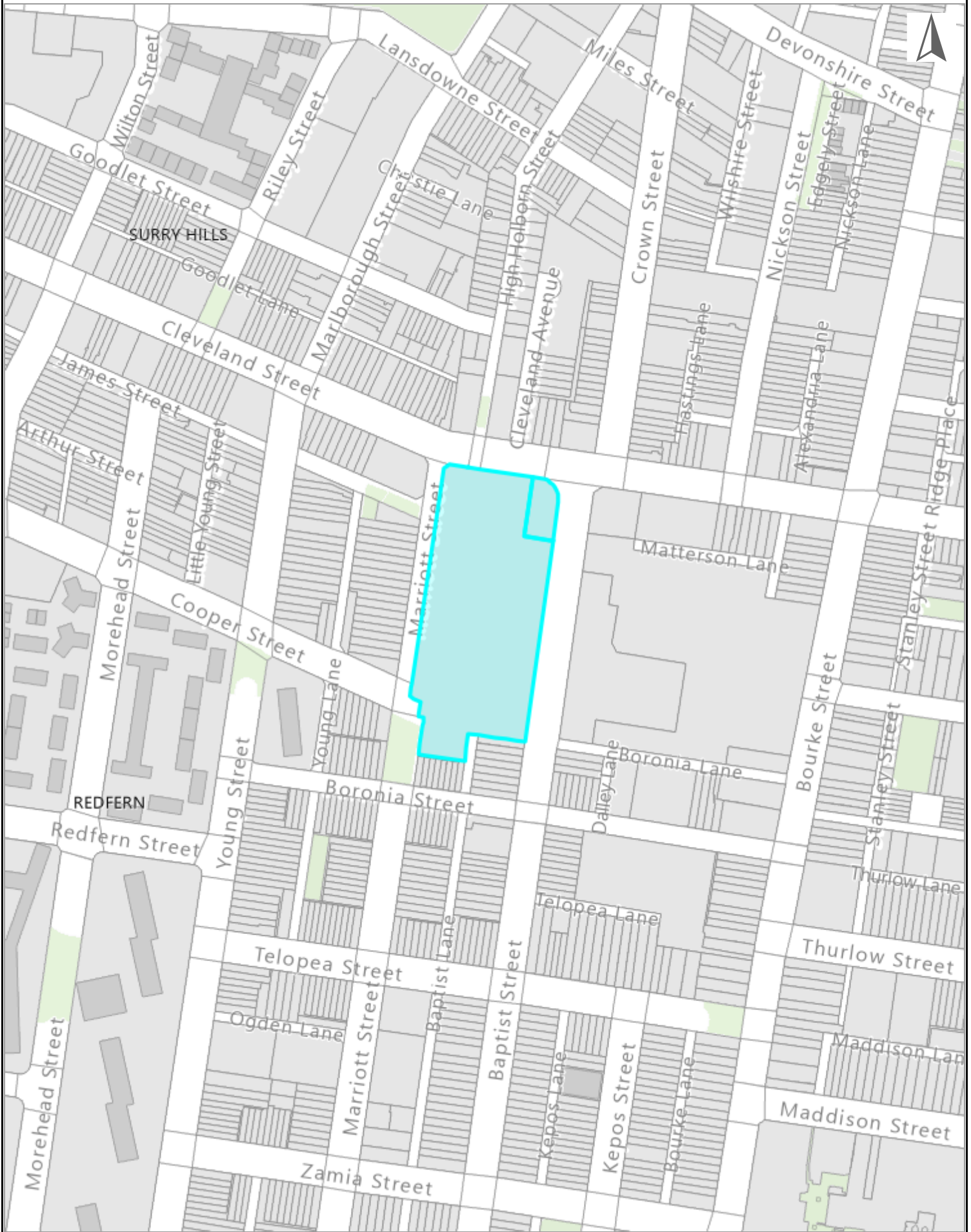

© City of Sydney Council 2024. All Rights Reserved.
This map has been compiled from various sources and the publisher and/or contributors accept no responsibility for any injury, loss or damage arising from the use, error or omissions therein. While all care is taken to ensure a high degree of accuracy, users are invited to notify Council's Spatial Services of any map discrepancies.
No part of this map may be reproduced without written permission.

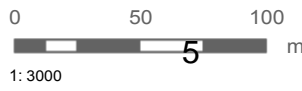

Notes

Proposed Plan of Subdivision - Dedication Lots 5 and 7 adjoining Baptist Lane

310 APPROVAL 13
 DWG No. - 2001 - Flow Plan - Lower Ground
 RECEIVED 17 MARCH 2025

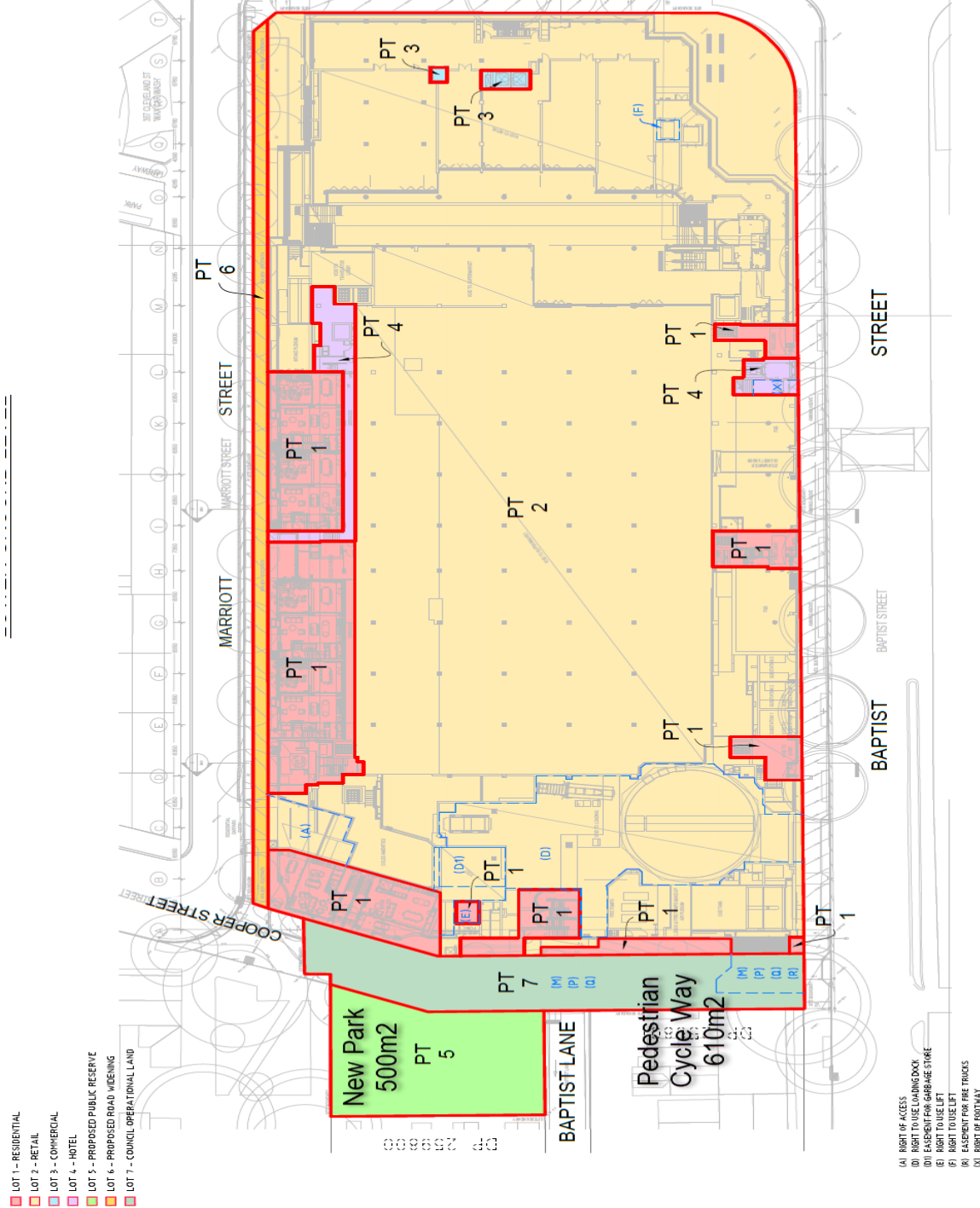

- LOT 1 - RESIDENTIAL
- LOT 2 - RETAIL
- LOT 3 - COMMERCIAL
- LOT 4 - HOTEL
- LOT 5 - PROPOSED PUBLIC RESERVE
- LOT 6 - PROPOSED ROAD WIDENING
- LOT 7 - COUNCIL OPERATIONAL LAND

- (A) RIGHT OF ACCESS
- (D) RIGHT TO USE LOADING DOCK
- (I) EASEMENT FOR GARAGE STORE
- (M) RIGHT TO USE LIFT
- (P) RIGHT TO USE LIFT
- (Q) EASEMENT FOR FIRE TRUCKS
- (R) RIGHT OF FOOTWAY

PRELIMINARY PLAN
 PREPARED BY
 GEORGE WILLIAMS